

# MALTA TOWNSHIP SECTION 22 R-12 TWP-10 MORGAN COUNTY, OH

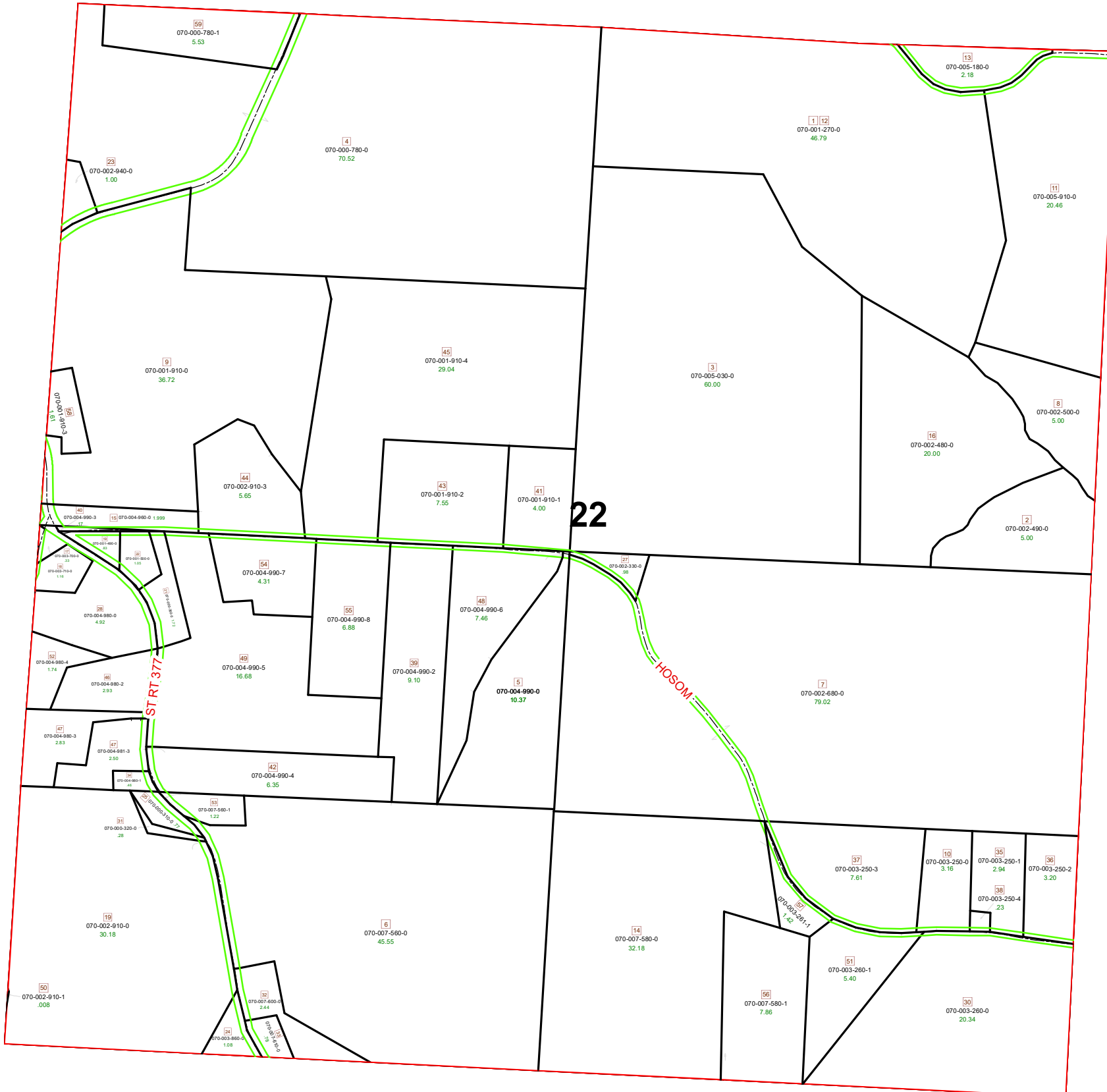

PIN	VOL	PAG	Owner	LegalDescr	Acres
070-004-990-0	OR191	553	APPERSON CORY ALLEN	R12 T10 S22 SD 5	10.378
070-000-320-0	D.V 149	205	BARKHURST JOHN O JR & MARJORIE	R12 T10 S22 SD 31	0.28
070-004-980-1	D.V 185	355	BARKHURST JOHN O JR & MARJORIE	R12 T10 S22 SD 34	0.466
070-000-310-0	D.V 185	355	BARKHURST JOHN O JR & MARJORIE	R12 T10 S22 SD 25	0.77
070-001-910-1	OR196	598	BONE SCOTT M	R12 T10 S22 SD 41	4
070-002-330-0	OR91	701	BRADY NATHAN L	R12 T10 S22 SD 27	0.98
070-000-350-0	OR220	197	BURNSIDE RICKEY W & DEBBIE A	R12 T10 S22 SD 21	1.72
070-004-990-3	OR115	126	CASTO RICHARD B II & ATHENA	R12 T10 S22 SD 40	0.171
070-004-980-0	OR115	126	CASTO RICHARD B II & ATHENA	R12 T10 S22 SD 28	4.922
070-004-980-4	OR75	235	CASTO RICHARD B II & ATHENA E	R12 T10 S22 SD 52	1.745
070-004-980-2	OR75	235	CASTO RICHARD B II & ATHENA E	R12 T10 S22 SD 46	2.932
070-002-910-0	OR40	76	CROUSE RAY C JR & MARILYN A	R12 T10 S22 SD 19	30.182
070-004-990-5	OR220	3081	DEW JAMES A & SHANNA L	R12 T10 S22 SD 49	16.685
070-001-910-4	OR8	332	FERGUSON RICHARD O JR	R12 T10 S22 SD 45	29.043
070-005-180-0	OR204	3371	GOINS JERRY H	R12 T10 S22 SD 13	2.18
070-001-270-0	OR206	208	GOINS JERRY HAYWARD	R12 T10 S22 SD 1-1	46.556
070-005-910-0	OR130	342	GOINS JERRY HAYWARD	R12 T10 S22 SD 11	20.46
070-002-490-0	OR204	3371	GOINS JERRY HAYWARD TRUSTEE	R12 T10 S22 SD 2	5
070-002-500-0	OR204	3371	GOINS JERRY HAYWARD TRUSTEE	R12 T10 S22 SD 8	5
070-002-480-0	OR204	3371	GOINS JERRY HAYWARD TRUSTEE	R12 T10 S22 SD 16	20
070-002-680-0	D.V 187	738	GREJUEY JUDY K	R12 T10 S22 SD 7 E	79.02
070-003-250-4	OR211	2804	HOSOM NANCY A	R12 T10 S22 SD 38	0.235
070-003-250-2	OR211	2804	HOSOM NANCY A	R12 T10 S22 SD 36	3.206
070-003-250-1	OR211	2804	HOSOM NANCY A	R12 T10 S22 SD 35	2.944
070-003-260-0	OR32	209	HOSOM REX O	R12 T10 S22 SD 30	20.346
070-000-780-0	OR18	104	KERNS CHARLES B & LULA R	R12 T10 S22 SD 4 S	70.526
070-002-940-0	OR198	575	KERNS CHARLES BOYD & LULA ROSE	R12 T10 S22 SD 23	1
070-001-490-0	OR233	2096	MAYLE STACY R & ROGER DALE	R12 T10 S22 SD 19	0.83
070-001-500-0	OR233	2096	MAYLE STACY R & ROGER DALE	R12 T10 S22 SD 22	1.05
070-003-261-1	OR137	359	MCCOY CLINT D & AMANDA M	R12 T10 S22 SD 57	1.42
070-003-260-1	OR214	1139	MCDANIEL DEREK E & THERESA M	R12 T10 S22 SD 51	5.404
070-003-860-0	OR205	1508	MCLEAN TARA M	R12 T10 S22 SD 24	1.086
070-004-990-7	OR225	2544	MEADOWS KIMBERLY D	R12 T10 S22 SD 54	4.317
070-002-910-3	OR229	80	MEADOWS SCOTT M	R12 T10 S22 SD 44	5.657
070-004-990-2	OR229	66	MEADOWS SCOTT M & KIMBERLY D	R12 T10 S22 SD 39	9.104
070-007-580-1	OR81	630	MILLER JAMES B & CHERYL D	R12 T10 S22 SD 56	7.86
070-007-580-0	OR202	3185	MILLER JAMES B & CHERYL D	R12 T10 S22 SD 14	32.18
070-007-560-0	OR202	3185	MILLER JAMES B & CHERYL D	R12 T10 S22 SD 6 S	45.555
070-007-560-1	OR203	1000	MILLER JAMES B & CHERYL D	R12 T10 S22 SD 53	1.225
070-004-990-4	OR2	718	MILLER JAMES B & CHERYL D	R12 T10 S22 SD 42	6.35
070-004-980-3	OR227	3019	MORROW BLAKE A & WAINWRIGHT SYDNEY T	R12 T10 S22 SD 47	2.835

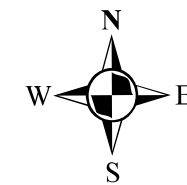

Boundaries	
----- Hidden	----- ROW
----- Hydro	----- Section
----- Roads	----- Lot
----- County	----- Parcel
----- Township	----- Parcels



Disclaimer: The information that these maps contains is for reference purposes only. Please bring any erros to the attention of the Engineer's Office staff.

Thank you

# MALTA TOWNSHIP SECTION 22 R-12 TWP-10 MORGAN COUNTY, OH

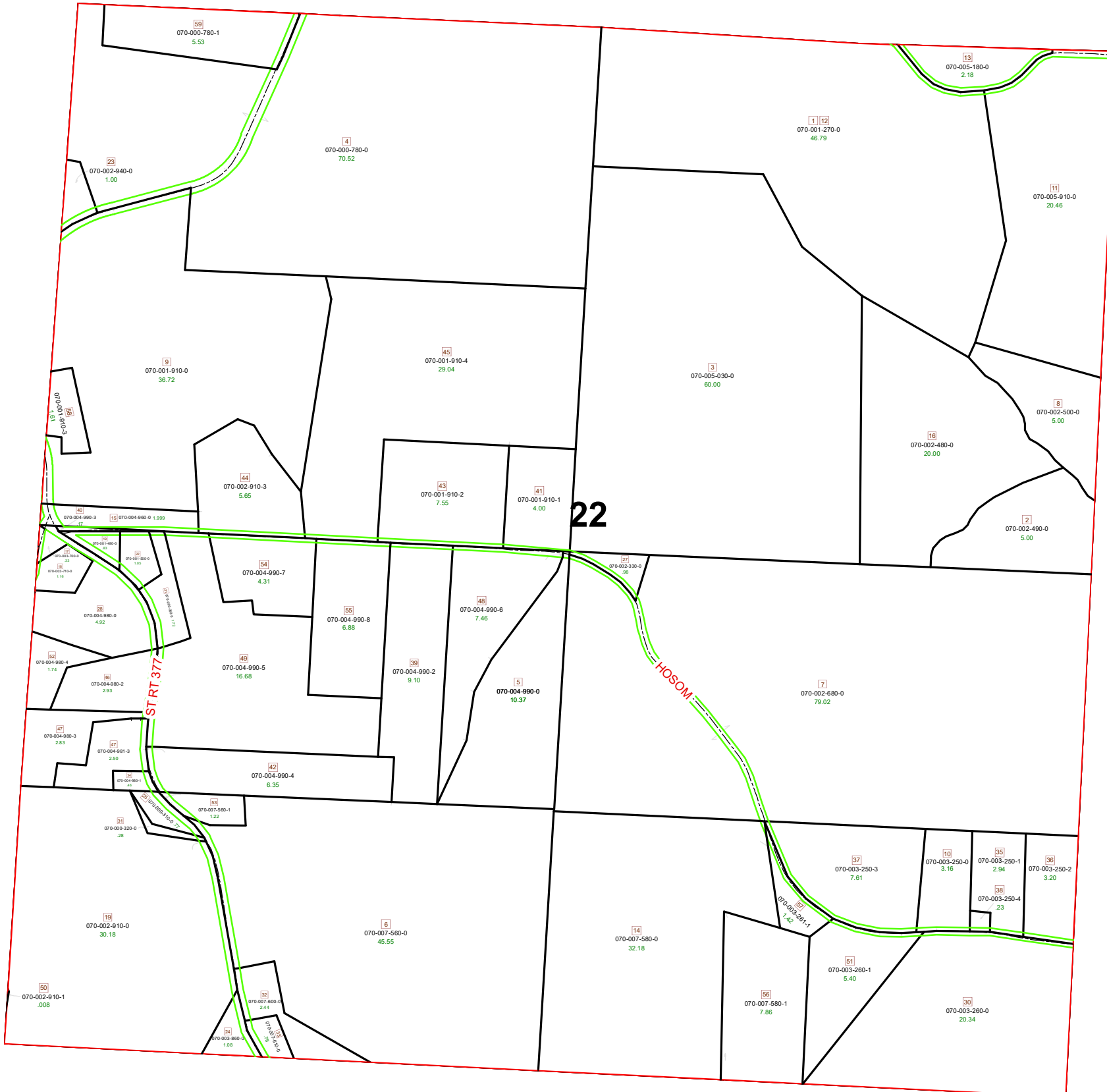

PIN	VOL	PAG	Owner	LegalDescr	Acres
070-005-030-0	OR207	136	RAYBURN WILLIAM A & PEGGY A	R12 T10 S22 SD 3 S	60
070-004-960-0	OR231	5736	RICHARDSON CHARLES E & MISTY DAWN CROSTO	R12 T10 S22 SD 15	1.999
070-000-780-1	OR194	293	SCOTT DAN K & DEBORAH L	R12 T10 S22 SD 59	5.534
070-001-910-3	OR226	3048	STRODE RICHARD L JR & DEBRA J & RYAN E	R12 T10 S22 SD 58	1.616
070-001-910-0	OR226	3048	STRODE RICHARD L JR & DEBRA J & RYAN E	R12 T10 S22 SD 9	36.72
070-007-610-0	OR206	3027	WATTS ROBERT LC-JEFF & CHARITY WORK	R12 T10 S22 SD 33	0.78
070-007-600-0	OR206	3027	WATTS ROBERT LC-JEFF & CHARITY WORK	R12 T10 S22 SD 32	2.44
070-001-910-2	OR202	3185	WEAVER MARVIN N & LORA R	R12 T10 S22 SD 43	7.551
070-004-990-6	OR231	3729	WESTGERDES RYAN	R12 T10 S22 SD 48	7.46
070-003-250-0	OR227	1644	WHITE MARILYN S & RICHARD LEE NEWTON JR	R12 T10 S22 SD 10	3.168
070-003-250-3	OR227	1644	WHITE MARILYN S & RICHARD LEE NEWTON JR	R12 T10 S22 SD 37	7.613
070-004-981-3	OR227	3015	WHITED SHANNON S	R12 T10 S22 SD 60	2.5
070-004-990-8	OR62	71	WILSON SHARMA	R12 T10 S22 SD 55	6.887

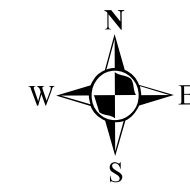

Boundaries	
----- Hidden	--- ROW
----- Hydro	--- Section
----- Roads	--- Township
----- County	--- Parcels
----- Lot	--- Parcel



Disclaimer: The information that these maps contains is for reference purposes only. Please bring any erros to the attention of the Engineer's Office staff.

Thank you